

Parts List

Thank you for choosing the Polycom® SoundStation IP 7000, a conference telephone that provides high quality audio conferencing over an IP network.

These items are included in your SoundStation IP 7000 package. If you are missing any items, contact your SoundStation IP 7000 reseller.

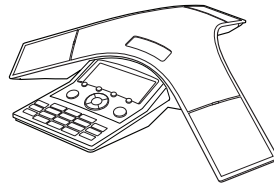

SoundStation IP 7000



Quick Start Guide

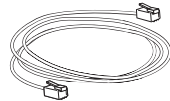

Network Cable

Optional Accessories

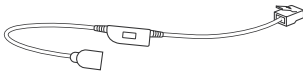

Power Interface Cable

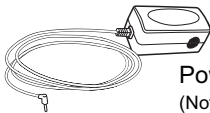

Power Adapter
(Not shown: Country-Specific Power Cable)

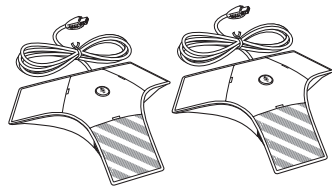

External Microphones

Installation

To install the SoundStation IP 7000, plug one end of the network cable into the network port on the bottom of the SoundStation IP 7000 console, and plug the other end of the network cable into your data port with PoE.

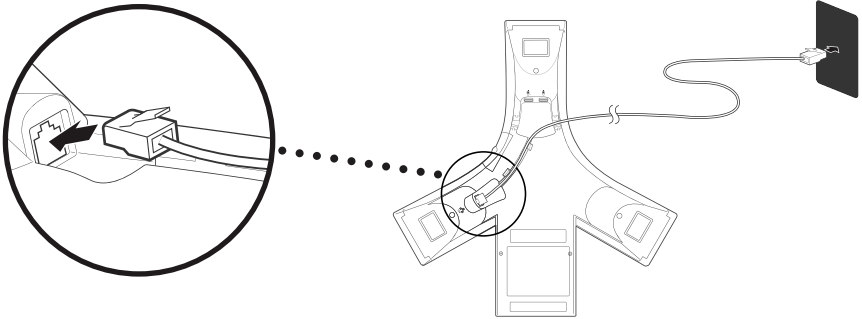

External Microphone

Connect external microphones (optional accessory), as shown below.

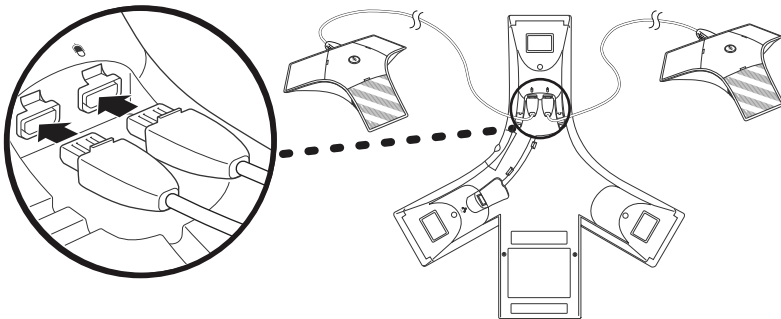

Features

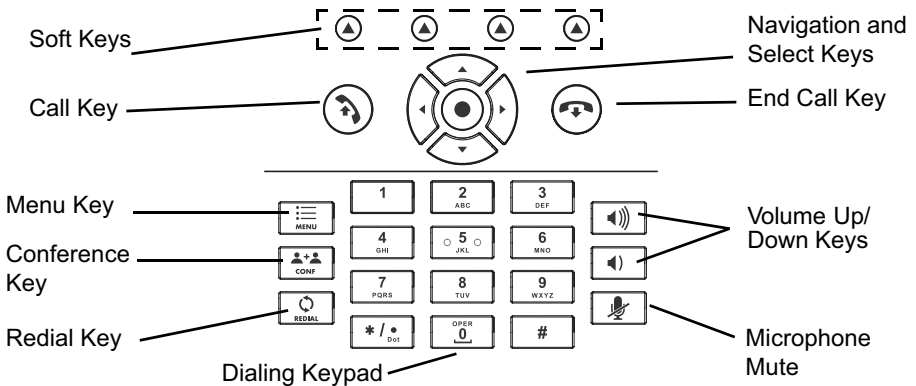
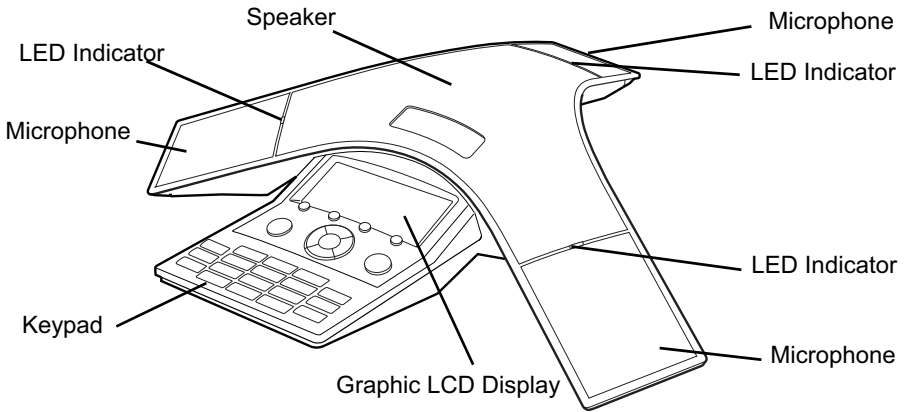

Startup

After it has been connected to the network, the SoundStation IP 7000 automatically powers up via Power over Ethernet (PoE), and begins a process of establishing itself on the network. When this is complete, the Idle screen is displayed (as shown on the right).

For more information, refer to the SoundStation IP 7000 User Guide, available online at:
<http://support.polycom.com/voice>

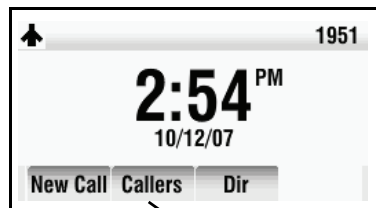

Idle Screen

