



# QUICK START

POLY STUDIO X50 TO STUDIO X52  
VESA TOP MOUNT UPDATE

 [poly.com/support/studio-x52](https://poly.com/support/studio-x52)



Recyclable where facilities exist



1725-88341-001A 05.23

## CONTENTS

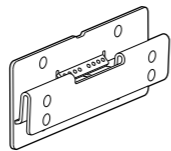

2342-87904-001



(4) M4 x 8  
Screw

## TOOL NEEDED

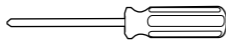

Phillips Screwdriver

## VESA TOP MOUNT 2

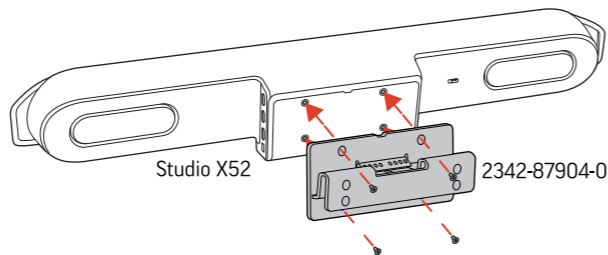

Studio X52

2342-87904-001

 x4



## VESA TOP MOUNT

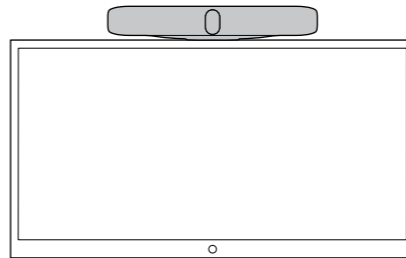

## VESA TOP MOUNT 3

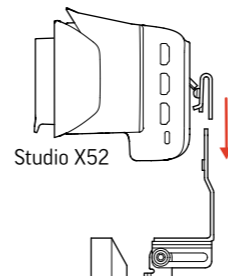

Studio X52

## VESA TOP MOUNT 1



Studio X50

## VESA TOP MOUNT 4

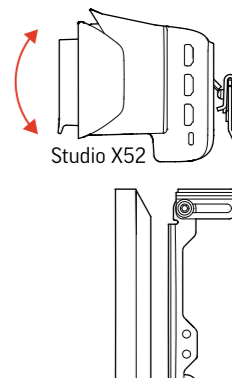

Studio X52



# QUICK START

POLY STUDIO X50 TO STUDIO X52  
VESA BOTTOM MOUNT UPDATE

## CONTENTS

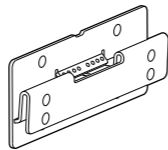

2342-87904-001



(4) M4 x 8  
Screw

## TOOL NEEDED

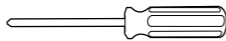

Phillips Screwdriver

## VESA BOTTOM MOUNT

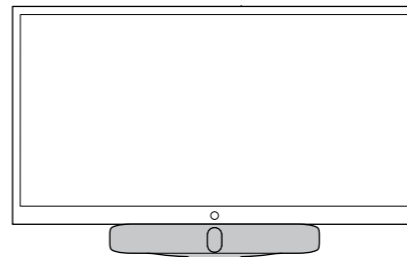

## VESA BOTTOM MOUNT 1

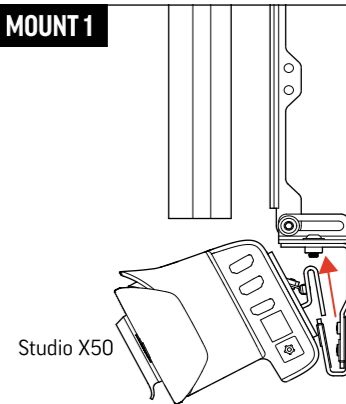

Studio X50

## VESA BOTTOM MOUNT 2

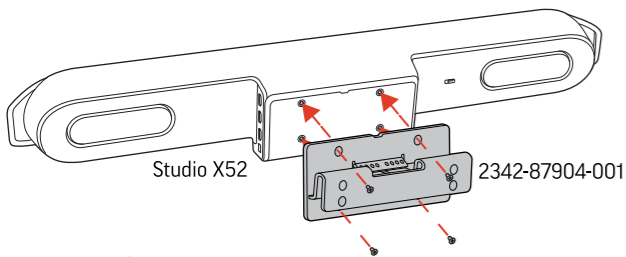

Studio X52

2342-87904-001



x4

## VESA BOTTOM MOUNT 3

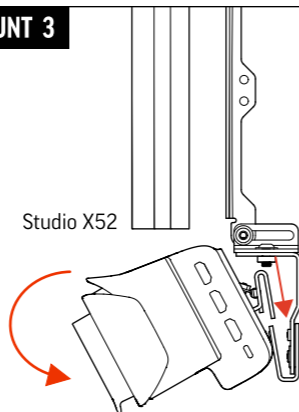

Studio X52

## VESA BOTTOM MOUNT 4

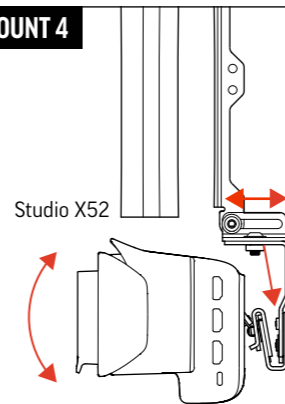

Studio X52