

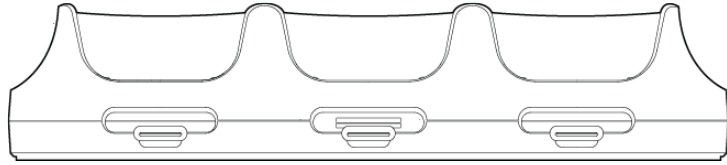

POLY ROVE DECT IP PHONE MULTICHARGER SETUP SHEET

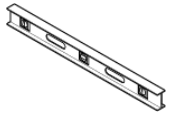

TOOLS NEEDED



PACKAGE CONTENTS

Multicharger

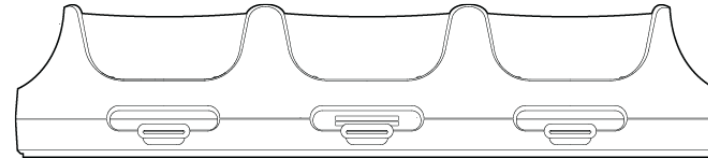

5V USB Power Adapter

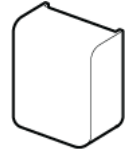

Regional USB Power Adapter Faceplates x 4



3.5x28 mm/
.13x1.10 in.



2.5x8 mm/
1x.31 in.



FEATURES

Phone Charging Ports

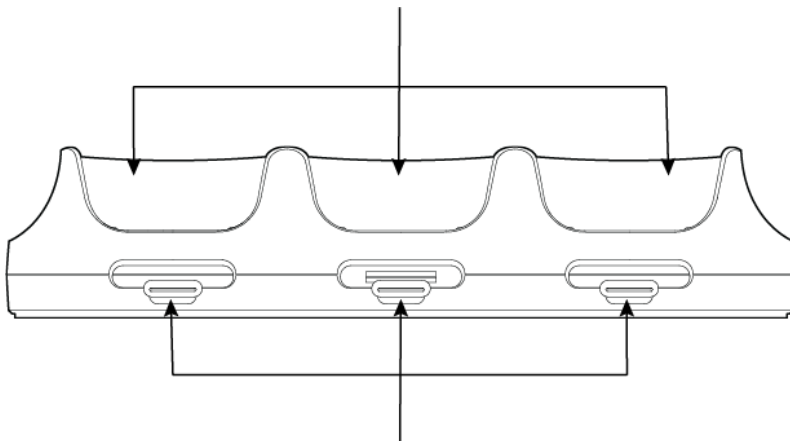

Individual Battery Charging Ports
with LED Status Indicators

CONNECT POWER

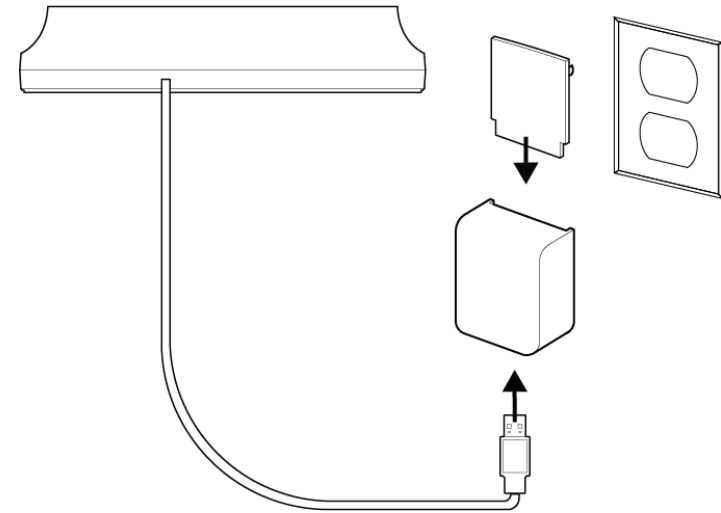

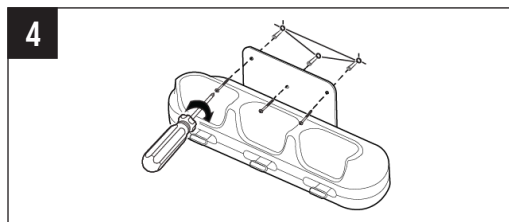
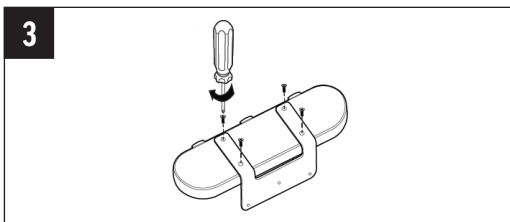
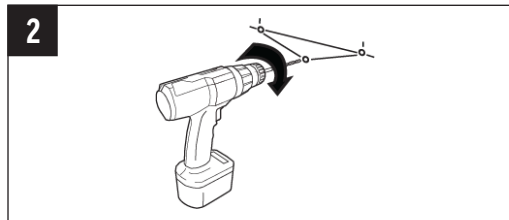
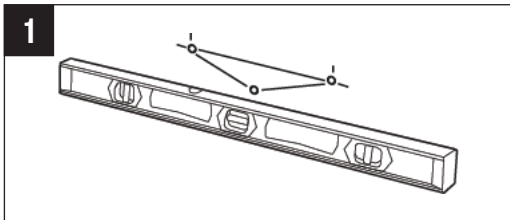
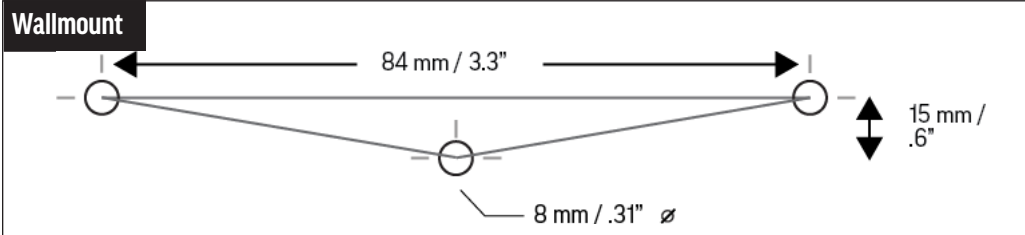

BY USING THIS PRODUCT, YOU ARE AGREEING TO THE TERMS OF THE END USER LICENSE AGREEMENT (EULA) AT: <http://documents.polycom.com/indexes/licenses>. IF YOU DO NOT AGREE TO THE TERMS OF THE EULA, DO NOT USE THE PRODUCT, AND YOU MAY RETURN IT IN THE ORIGINAL PACKAGING TO THE SELLER FROM WHOM YOU PURCHASED THE PRODUCT. Refer to the Limited Warranty section of the Product Warranty Guide found under Services at <http://support.polycom.com/>

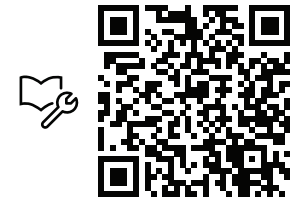

support.polycom.com/voice



© 2021 Plantronics, Inc. All rights reserved. Poly, the propeller design, and the Poly logo are trademarks of Plantronics, Inc. All other trademarks are the property of their respective owners.
 Contact Information:
 Contact your authorized reseller for assistance.
www.poly.com
 Plantronics, Inc. 345 Encinal Street Santa Cruz, California 95060



3725-34008-001A